

A

Spears® Copper Tube Size (CTS) fittings are manufactured from chlorinated polyvinyl chloride (CPVC) for use with SDR 11 piping systems of CTS outside diameter in hot and cold water distribution systems. Check state and local codes for application and restrictions.

C S

Spears® CPVC CTS fittings conform to ASTM D2846 Specification for Chlorinated Poly (Vinyl Chloride) (CPVC) Plastic Hot and Cold Water Distribution Systems.

W P

Spears® CPVC CTS fittings have a continuous working pressure rating of 100 psi at 180°F (400 psi at 73°F).

P C

Spears® CPVC CTS fittings and Special Reinforced (SR) Thread transition adapters are tested and certified by the National Sanitation Foundation (NSF) to ASTM D 2846 for use in Hot and Cold Water Distribution Systems, and for safe use in potable water systems under NSF Standard 14/61.

T

Once the system has been installed and allowed to cure properly, the system shall be tested in accordance with applicable code requirements. When testing with water (hydrostatic testing), the system must be slowly filled with water and the air bled from the highest and furthest points in the system before test pressure is applied. Failure to do so can cause damage to the piping system and could be harmful to the job site personnel should a failure occur. If a leak is found, the affected product must be cut and discarded. A new section can be installed using couplings or other approved means.

WARNING: THE USE OF COMPRESSED AIR OR GASES FOR TESTING MAY RESULT IN SYSTEM DAMAGE OR SERIOUS OR FATAL BODILY INJURY.

CPVC 41, SDR 11 PIPE DIMENSIONS (CTS) ASTM D 2846, D 2846M			
N P S I.	M O I.	O. D. T I.	M W T I.
1/2	0.625	±0.003	0.068
3/4	0.875	±0.003	0.080
1	1.125	±0.003	0.102
1-1/4	1.375	±0.003	0.125
1-1/2	1.625	±0.004	0.148
2	2.125	±0.004	0.193

CPVC 41, SDR 11 PIPE DIMENSIONS (CTS) ASTM D 2846, D 2846M				
N S I.	D			S L M C
	E A	B B	T I.	
1/2	0.633	0.619	±0.003	0.500
3/4	0.884	0.870	±0.003	0.700
1	1.135	1.121	±0.003	0.900
1-1/4	1.386	1.372	±0.003	1.100
1-1/2	1.640	1.622	±0.004	1.300
2	2.141	2.123	±0.004	1.700

I M D R

G = (LAYING LENGTH) intersection of center lines to bottom of socket/thread; 90° elbows, tees, crosses; ± 1/32 inch.

H = Intersection of center lines to face of fitting; 90° elbows, tees, crosses; ± 1/32 inch.

J = Intersection of center lines to bottom of socket/thread; 45° elbows; ± 1/32 inch.

L = Overall length of fittings; ± 1/16 inch.

M = Outside diameter of socket/thread hub; ± 1/16 inch.

N = Socket bottom to socket bottom; couplings; ± 1/16 inch.

W = Height of cap; ± 1/16 inch

COPPER TUBE SIZE CTS CPVC PIPE						
N P S I.	A G. O.D.	A G. I.D.	MIN. W	MA W.P. P.S.I.	LBS. FT.	L C
1/2	0.625	0.469	0.068	400	.090	50
3/4	0.875	0.695	0.080	400	.149	25
1	1.125	0.901	0.102	400	.240	15
1-1/4	1.375	1.105	0.125	400	.353	10
1-1/2	1.625	1.309	0.148	400	.489	6
2	2.125	1.716	0.193	400	.829	4

Standard Length - 10 Feet • All pipe is packed in boxes sold in carton quantities only.
Pipe has UL 94 V-O rating • * For water, non shock, at 73.4°F with solvent welded joints.

CPVC CTS FITTINGS & VALVES

TEE

Socket x Socket x Socket

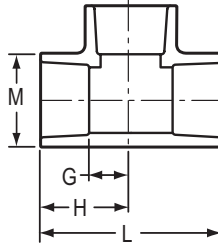

P N	S	G	H	L	M	A . W . L .
4101-005	1/2	7/16	15/16	1-7/8	13/16	.03
4101-007	3/4	17/32	1-1/4	2-1/2	1-3/32	.06
4101-010	1	11/16	1-19/32	3-5/32	1-11/32	.11
4101-012	1-1/4	13/16	1-29/32	3-25/32	1-21/32	.18
4101-015	1-1/2	15/16	2-1/4	4-15/32	1-31/32	.29
4101-020	2	1-3/16	2-29/32	5-25/32	2-9/16	.62

DROP EAR TEE

(Fitting With Bracket)

Socket x Socket x Socket

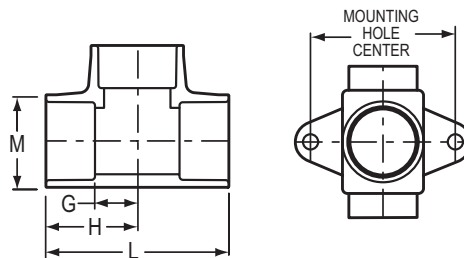

P N	S	G	H	L	M	M _C H	A . W . L .
DE4101-005	1/2	13/32	15/16	1-7/8	27/32	1-3/4	.04

REDUCING TEE

Socket x Socket x Socket

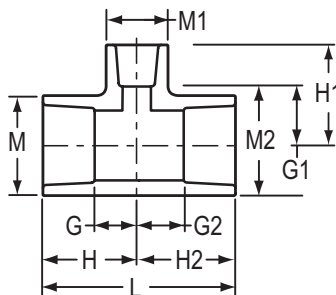

P N	S	G	G	G	H	H	H	L	M	M	M	A . W . L .
4101-074	1/2x1/2x3/4	7/16	13/32	31/32	31/32	1-1/8	31/32	1-15/16	27/32	1-3/32	27/32	.04

CPVC CTS FITTINGS & VALVES

REDUCING TEE (continued)

Socket x Socket x Socket

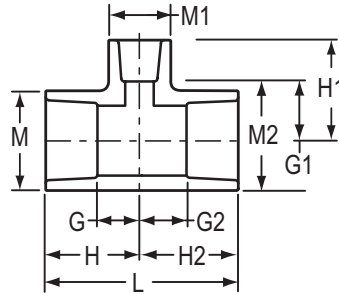

P N	S	G	G	G	H	H	H	L	M	M	M	A W . L .
4101-094	3/4x1/2x1/2	7/16	17/32	7/16	1-5/32	1-1/16	31/32	2-1/8	1-3/32	27/32	27/32	.06
4101-095	3/4x1/2x3/4	17/32	9/16	19/32	1-1/4	1-9/32	1-1/8	2-3/8	1-3/32	1-3/32	27/32	.05
4101-101	3/4x3/4x1/2	7/16	17/32	1-1/8	1-5/32	1-1/16	1-1/8	2-9/32	1-3/32	27/32	1-3/32	.05
4101-102*	3/4x3/4x1	1-1/8	11/16	1-13/16	1-27/32	1-19/32	1-13/16	3-21/32	1-11/32	1-11/32	1-11/32	.16
4101-120*	1x1/2x1/2	11/16	1-5/16	1-1/4	1-19/32	1-27/32	1-25/32	3-3/8	1-11/32	1-11/32	1-11/32	.20
4101-121*	1x1/2x3/4	11/16	1-1/8	1-1/4	1-19/32	1-27/32	1-25/32	3-3/8	1-11/32	1-11/32	1-11/32	.18
4101-122*	1x1/2x1	11/16	11/16	1-1/4	1-19/32	1-19/32	1-25/32	3-3/8	1-11/32	1-11/32	1-11/32	.15
4101-124*	1x3/4x1/2	11/16	1-5/16	1-1/16	1-19/32	1-27/32	1-25/32	3-3/8	1-11/32	1-11/32	1-11/32	.18
4101-125*	1x3/4x3/4	11/16	1-1/8	1-1/16	1-19/32	1-27/32	1-25/32	3-3/8	1-11/32	1-11/32	1-11/32	.16
4101-126*	1x3/4x1	11/16	15/16	1-1/16	1-19/32	1-27/32	1-25/32	3-3/8	1-11/32	1-11/32	1-11/32	.13
4101-130*	1x1x1/2	11/16	1-1/16	1-9/16	1-19/32	1-19/32	1-9/16	3-5/32	1-11/32	1-11/32	1-11/32	.15
4101-131*	1x1x3/4	11/16	7/8	1-9/16	1-19/32	1-19/32	1-9/16	3-5/32	1-11/32	1-11/32	1-11/32	.09
4101-138*	1-1/4x1/2x1/2	13/16	1-11/16	1-21/32	1-29/32	2-7/32	2-3/16	4-3/32	1-21/32	1-21/32	1-21/32	.30
4101-139*	1-1/4x1/2x3/4	13/16	1-1/2	1-21/32	1-29/32	2-7/32	2-3/16	4-3/32	1-21/32	1-21/32	1-21/32	.30
4101-142*	1-1/4x1/2x1-1/4	13/16	27/32	1-21/32	1-29/32	1-15/16	2-3/16	4-3/32	1-21/32	1-21/32	1-21/32	.24
4101-146*	1-1/4x3/4x1/2	13/16	1-11/16	1-15/32	1-29/32	2-7/32	2-3/16	4-3/32	1-21/32	1-21/32	1-21/32	.30
4101-147*	1-1/4x3/4x3/4	13/16	1-1/2	1-15/32	1-29/32	2-7/32	2-3/16	4-3/32	1-21/32	1-21/32	1-21/32	.31
4101-148*	1-1/4x3/4x1	13/16	1-5/16	1-15/32	1-29/32	2-7/32	2-3/16	4-3/32	1-21/32	1-21/32	1-21/32	.29
4101-149*	1-1/4x3/4x1-1/4	25/32	25/32	1-7/16	1-29/32	1-29/32	2-3/16	4-3/32	1-21/32	1-21/32	1-21/32	.26
4101-156*	1-1/4x1x1/2	13/16	1-21/32	1-1/4	1-29/32	2-3/16	2-5/32	4-1/16	1-21/32	1-21/32	1-21/32	.30
4101-157*	1-1/4x1x3/4	13/16	1-1/2	1-9/32	1-29/32	2-7/32	2-3/16	4-3/32	1-21/32	1-21/32	1-21/32	.29
4101-158*	1-1/4x1x1	13/16	1-5/16	1-9/32	1-29/32	2-7/32	2-3/16	4-3/32	1-21/32	1-21/32	1-21/32	.27
4101-159*	1-1/4x1x1-1/4	13/16	27/32	1-9/32	1-29/32	1-15/16	2-3/16	4-3/32	1-21/32	1-21/32	1-21/32	.22
4101-166*	1-1/4x1-1/4x1/2	11/16	1-15/32	11/16	1-29/32	2	1-7/8	3-9/16	1-21/32	1-3/8	1-21/32	.21
4101-167*	1-1/4x1-1/4x3/4	13/16	1-1/2	1-7/8	1-29/32	2-7/32	1-7/8	3-25/32	1-21/32	1-21/32	1-21/32	.19
4101-168*	1-1/4x1-1/4x1	13/16	1-5/16	1-7/8	1-29/32	2-7/32	1-7/8	3-25/32	1-21/32	1-21/32	1-21/32	.16
4101-169*	1-1/4x1-1/4x1-1/2	1-7/16	15/16	2-1/32	2-17/32	2-1/4	2-17/32	5-1/16	1-31/32	1-31/32	1-31/32	.41
4101-173*	1-1/2x1/2x1/2	15/16	2-1/32	2-1/32	2-1/4	2-9/16	2-9/16	4-13/16	1-31/32	1-31/32	1-31/32	.49
4101-174*	1-1/2x1/2x3/4	15/16	1-27/32	2-1/32	2-1/4	2-9/16	2-9/16	4-13/16	1-31/32	1-31/32	1-31/32	.49
4101-175*	1-1/2x1/2x1	11/16	1	1-13/16	2	1-29/32	2-11/32	4-11/32	1-31/32	1-3/8	1-31/32	.48
4101-176*	1-1/2x1/2x1-1/4	15/16	1-15/32	2-1/32	2-1/4	2-9/16	2-9/16	4-13/16	1-31/32	1-31/32	1-31/32	.45
4101-177*	1-1/2x1/2x1-1/2	15/16	15/16	2-1/32	2-1/4	2-1/4	2-9/16	4-13/16	1-31/32	1-31/32	1-31/32	.39
4101-182*	1-1/2x3/4x1/2	15/16	2-1/32	1-27/32	2-1/4	2-9/16	2-9/16	4-13/16	1-31/32	1-31/32	1-31/32	.49

CPVC CTS FITTINGS & VALVES

REDUCING TEE (continued) Socket x Socket x Socket

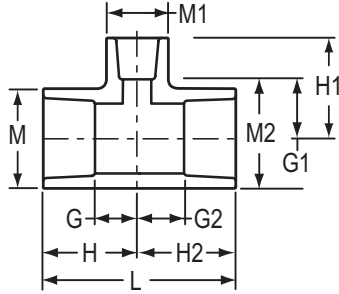

P N	S	G	G	G	H	H	H	L	M	M	M	A W . L .
4101-184*	1-1/2x3/4x3/4	15/16	1-27/32	1-27/32	2-1/4	2-9/16	2-9/16	4-13/16	1-31/32	1-31/32	1-31/32	.48
4101-185*	1-1/2x3/4x1	1-1/32	1-5/8	1-27/32	2-1/4	2-9/16	2-9/16	4-23/32	1-31/32	1-31/32	1-31/32	.48
4101-186*	1-1/2x3/4x1-1/4	3/4	1-7/16	1-5/16	2-9/16	2-9/16	2-1/4	4-13/16	1-31/32	1-31/32	1-31/32	.44
4101-188*	1-1/2x3/4x1-1/2	15/16	15/16	1-27/32	2-1/4	2-1/4	2-9/16	4-13/16	1-31/32	1-31/32	1-31/32	.39
4101-193*	1-1/2x1x1/2	15/16	2-1/32	1-21/32	2-1/4	2-9/16	2-9/16	4-13/16	1-31/32	1-31/32	1-31/32	.48
4101-194*	1-1/2x1x3/4	15/16	1-27/32	1-21/32	2-1/4	2-9/16	2-9/16	4-13/16	1-31/32	1-31/32	1-31/32	.48
4101-195*	1-1/2x1x1	15/16	1-21/32	1-21/32	2-1/4	2-9/16	2-9/16	4-27/32	1-31/32	1-31/32	1-31/32	.48
4101-196*	1-1/2x1x1-1/4	15/16	1-15/32	1-11/16	2-1/4	2-9/16	2-19/32	4-27/32	1-31/32	1-31/32	1-31/32	.44
4101-197*	1-1/2x1x1-1/2	15/16	15/16	1-21/32	2-1/4	2-1/4	2-9/16	4-13/16	1-31/32	1-31/32	1-31/32	.38
4101-199*	1-1/2x1-1/4x1/2	1-3/8	2-1/32	2-1/32	2-1/2	2-9/16	2-1/4	4-23/32	1-31/32	1-31/32	1-31/32	.45
4101-201*	1-1/2x1-1/4x3/4	15/16	1-27/32	1-15/32	2-1/4	2-9/16	2-9/16	4-13/16	1-31/32	1-31/32	1-31/32	.44
4101-202*	1-1/2x1-1/4x1	15/16	1-21/32	1-15/32	2-1/4	2-9/16	2-9/16	4-13/16	1-31/32	1-31/32	1-31/32	.44
4101-203*	1-1/2x1-1/4x1-1/4	15/16	1-15/32	1-15/32	2-1/4	2-9/16	2-9/16	4-13/16	1-31/32	1-31/32	1-31/32	.41
4101-204*	1-1/2x1-1/4x1-1/2	15/16	15/16	1-15/32	2-1/4	2-1/4	2-9/16	4-13/16	1-31/32	1-31/32	1-31/32	.35
4101-209*	1-1/2x1-1/2x1/2	11/16	1-1/2	2	2	2-3/16	2	4	1-31/32	1-3/8	1-31/32	.28
4101-210*	1-1/2x1-1/2x3/4	11/16	1-7/16	2	2	2-5/32	2	4	1-31/32	1-3/8	1-31/32	.26
4101-211	1-1/2x1-1/2x1	11/16	1-5/8	2	2	2-17/32	2	4	1-31/32	1-3/8	1-31/32	.23
4101-212*	1-1/2x1-1/2x1-1/4	15/16	1-7/16	2-7/32	2-1/4	2-17/32	2-7/32	4-15/32	1-31/32	1-31/32	1-31/32	.35
4101-213*	1-1/2x1-1/2x2	1-29/32	1-3/16	1-29/32	3-7/32	2-7/8	3-19/32	6-13/16	2-9/16	2-9/16	2-9/16	1.01
4101-216*	2x1/2x1/2	1-3/16	2-11/16	2-5/8	2-29/32	3-7/32	3-5/32	6-1/16	2-9/16	2-9/16	2-9/16	1.02
4101-217*	2x1/2x3/4	1-3/16	2-1/2	2-5/8	2-29/32	3-7/32	3-5/32	6-1/16	2-9/16	2-9/16	2-9/16	1.03
4101-218*	2x1/2x1	1-3/16	2-5/16	2-5/8	2-29/32	3-7/32	3-5/32	6-1/16	2-9/16	2-9/16	2-9/16	1.03
4101-219*	2x1/2x1-1/4	1-3/16	2-1/8	2-5/8	2-29/32	3-7/32	3-5/32	6-1/16	2-9/16	2-9/16	2-9/16	1.02
4101-220*	2x1/2x1-1/2	1-3/16	1-29/32	2-5/8	2-29/32	3-7/32	3-5/32	6-1/16	2-9/16	2-9/16	2-9/16	1.00
4101-221*	2x1/2x2	1-3/16	1-5/32	2-5/8	2-29/32	2-7/8	3-5/32	6-1/16	2-9/16	2-9/16	2-9/16	.82
4101-222*	2x3/4x1/2	1-3/16	2-11/16	2-11/16	2-29/32	3-7/32	3-5/32	6-1/16	2-9/16	2-9/16	2-9/16	1.03
4101-223*	2x3/4x3/4	1-3/16	2-1/2	2-7/16	2-29/32	3-7/32	3-5/32	6-1/16	2-9/16	2-9/16	2-9/16	1.04
4101-224*	2x3/4x1	1-3/16	2-5/16	2-7/16	2-29/32	3-7/32	3-5/32	6-1/16	2-9/16	2-9/16	2-9/16	1.04
4101-225*	2x3/4x1-1/4	1-5/32	2-1/16	2-7/16	2-7/8	3-5/32	3-5/32	6-1/16	2-9/16	2-9/16	2-9/16	1.03
4101-226*	2x3/4x1-1/2	1-3/16	1-29/32	2-7/16	2-29/32	3-7/32	3-5/32	6-1/16	2-9/16	2-9/16	2-9/16	1.01
4101-227*	2x3/4x2	1-3/16	1-5/32	2-7/16	2-29/32	2-7/8	3-5/32	6-1/16	2-9/16	2-9/16	2-9/16	.83
4101-228*	2x1x1/2	1-3/16	2-11/16	2-1/4	2-29/32	3-7/32	3-5/32	6-1/16	2-9/16	2-9/16	2-9/16	1.03
4101-229	2x1x3/4	1-23/32	2-1/2	2-1/4	2-7/8	3-3/16	3-7/32	6-3/32	2-9/16	2-9/16	2-9/16	1.04
4101-230*	2x1x1	1-3/16	2-5/16	2-1/4	2-29/32	3-7/32	3-5/32	6-1/16	2-9/16	2-9/16	2-9/16	1.05

CPVC CTS FITTINGS & VALVES

REDUCING TEE (continued)

Socket x Socket x Socket

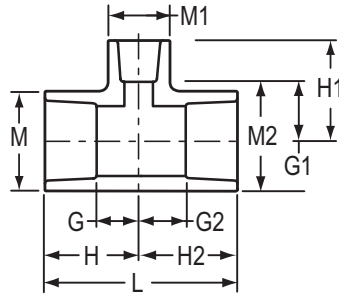

P N	S	G	G	G	H	H	H	L	M	M	M	A W . L .
4101-231*	2x1x1-1/4	1-3/16	2-1/8	2-1/4	2-29/32	3-7/32	3-5/32	6-1/16	2-9/16	2-9/16	2-9/16	1.04
4101-232*	2x1x1-1/2	1-3/16	1-29/32	2-1/4	2-29/32	3-7/32	3-5/32	6-1/16	2-9/16	2-9/16	2-9/16	1.02
4101-233*	2x1x2	1-3/16	1-5/32	2-1/4	2-29/32	2-7/8	3-5/32	6-1/16	2-9/16	2-9/16	2-9/16	.83
4101-234*	2x1-1/4x1/2	1-3/16	2-11/16	2-1/16	2-29/32	3-7/32	3-5/32	6-1/16	2-9/16	2-9/16	2-9/16	1.02
4101-235*	2x1-1/4x3/4	1-3/16	2-1/2	2-1/16	2-29/32	3-7/32	3-5/32	6-1/16	2-9/16	2-9/16	2-9/16	1.03
4101-236*	2x1-1/4x1	1-3/16	2-5/16	2-1/16	2-29/32	3-7/32	3-5/32	6-1/16	2-9/16	2-9/16	2-9/16	1.04
4101-237*	2x1-1/2x1/2	1-3/16	2-11/16	1-27/32	2-29/32	3-7/32	3-5/32	6-1/16	2-9/16	2-9/16	2-9/16	1.00
4101-238*	2x1-1/2x3/4	1-3/16	2-1/2	1-27/32	2-29/32	3-7/32	3-5/32	6-1/16	2-9/16	2-9/16	2-9/16	1.01
4101-239*	2x1-1/2x1	1-3/16	2-5/16	1-27/32	2-29/32	3-7/32	3-5/32	6-1/16	2-9/16	2-9/16	2-9/16	1.02
4101-240*	2x1-1/2x1-1/4	1-3/16	2-1/8	1-27/32	2-29/32	3-7/32	3-5/32	6-1/16	2-9/16	2-9/16	2-9/16	1.00
4101-241*	2x1-1/2x1-1/2	1-5/32	1-7/8	1-7/8	2-7/8	3-3/16	3-3/16	6-1/16	2-9/16	2-9/16	2-9/16	1.01
4101-242*	2x1-1/4x1-1/4	1-3/16	2-1/8	2-1/16	2-29/32	3-7/32	3-5/32	6-1/16	2-9/16	2-9/16	2-9/16	1.02
4101-243*	2x1-1/4x1-1/2	1-3/16	1-29/32	2-1/16	2-29/32	3-7/32	3-5/32	6-1/16	2-9/16	2-9/16	2-9/16	1.00
4101-244*	2x1-1/4x2	1-5/32	1-1/2	2-3/32	2-7/8	3-7/32	3-3/16	6-1/16	2-9/16	2-9/16	2-9/16	.82
4101-247*	2x2x1/2	21/32	1-7/8	21/32	2-3/8	2-13/32	2-3/8	4-25/32	2-9/16	1-3/8	2-9/16	.48
4101-248*	2x2x3/4	1-5/32	2-1/2	2-29/32	2-7/8	3-7/32	2-29/32	5-25/32	2-9/16	2-9/16	2-9/16	.46
4101-249	2x2x1	1-5/32	2-5/16	2-29/32	2-7/8	3-7/32	2-29/32	5-25/32	2-9/16	2-9/16	2-9/16	.43
4101-250*	2x2x1-1/4	1-5/32	2-3/8	1-5/32	2-7/8	3-7/32	2-7/8	5-25/32	2-9/16	2-9/16	2-9/16	.90
4101-251	2x2x1-1/2	1-5/32	1-29/32	2-29/32	2-7/8	3-7/32	2-29/32	5-25/32	2-9/16	2-9/16	2-9/16	.53
4101-257*	2x1-1/2x2	1-3/16	1-5/32	1-27/32	2-29/32	2-7/8	3-5/32	6-1/16	2-9/16	2-9/16	2-9/16	.80

CPVC CTS FITTINGS & VALVES

0 ELL

Socket x Socket

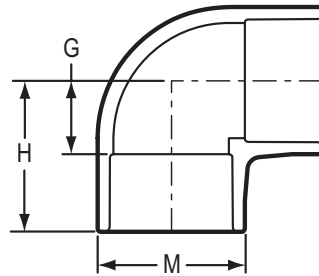

P	N	S	G	H	M	A	.W.L.
4106-005		1/2	3/8	15/16	7/8		.02
4106-007		3/4	9/16	1-1/4	1-1/8		.04
4106-010		1	11/16	1-9/16	1-3/8		.08
4106-012		1-1/4	13/16	1-29/32	1-21/32		.13
4106-015		1-1/2	15/16	2-1/4	1-31/32		.22
4106-020		2	1-3/16	2-29/32	2-9/16		.47

REDUCING 0 ELL

Socket x Socket

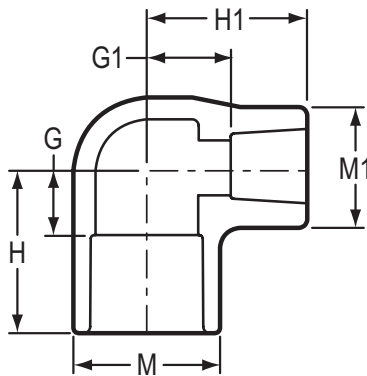

P	N	S	G	G	H	H	M	M	A	.W.L.
4106-101		3/4x1/2	17/32	17/32	1-1/4	1-1/16	1-3/32	27/32		.04
4106-167*		1-1/4x3/4	13/16	1-1/2	1-29/32	2-7/32	1-21/32	1-21/32		.20
4106-168*		1-1/4x1	13/16	1-5/16	1-29/32	2-7/32	1-21/32	1-21/32		.18
4106-209*		1-1/2x1/2	15/16	2-1/32	2-1/4	2-17/32	1-31/32	1-31/32		.32
4106-210*		1-1/2x3/4	15/16	1-27/32	2-1/4	2-9/16	1-31/32	1-31/32		.32
4106-211*		1-1/2x1	15/16	1-21/32	2-1/4	2-19/32	1-31/32	1-31/32		.31
4106-212*		1-1/2x1-1/4	15/16	1-13/32	2-1/4	2-17/32	1-31/32	1-31/32		.28
4106-247*		2x1/2	1-3/16	2-11/16	2-29/32	3-3/16	2-9/16	2-9/16		.67
4106-248*		2x3/4	1-3/16	2-7/16	2-29/32	3-5/32	2-9/16	2-9/16		.68
4106-249*		2x1	1-3/16	2-9/32	2-29/32	3-3/16	2-9/16	2-9/16		.68
4106-250*		2x1-1/4	1-3/16	2-1/16	2-29/32	3-5/32	2-9/16	2-9/16		.67
4106-251*		2x1-1/2	1-3/16	1-29/32	2-29/32	3-7/32	2-9/16	2-9/16		.65

CPVC CTS FITTINGS & VALVES

SPECIAL REINFORCED 0 ELL

Socket x SR Fipt

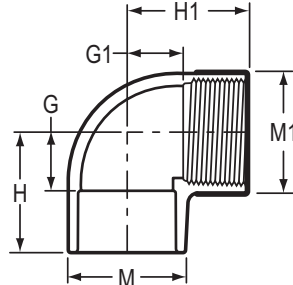

P	N	S	G	G	H	H	M	M	A	.W.L.
4107-005SR		1/2	13/32	13/32	15/16	1-5/32	27/32	1-7/32		.06

INC DROP EAR SPECIAL REINFORCED 0 ELL

(One Piece Unit)

Socket x SR Fipt

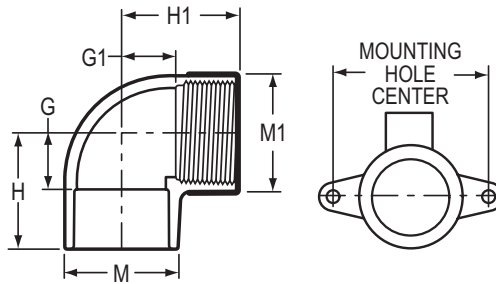

P	N	S	G	G	H	H	M	M	M _C	H	A	.W.L.
DEZ4107-005SR		1/2	1/4	3/8	25/32	1-5/32	27/32	1-7/32	2-1/16			.15

DROP EAR 0 ELL

(Fitting With Bracket)

Socket x Socket

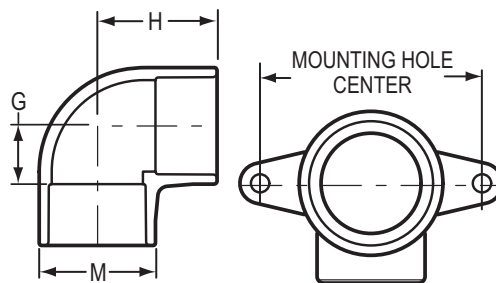

P	N	S	G	H	M	M _C	H	A	W.L.
DE4106-005		1/2	1/4	25/32	27/32	1-3/4			.03

CPVC CTS FITTINGS & VALVES

DROP EAR SPECIAL REINFORCED 0 ELL

(Fitting With Bracket)
Socket x SR Fipt

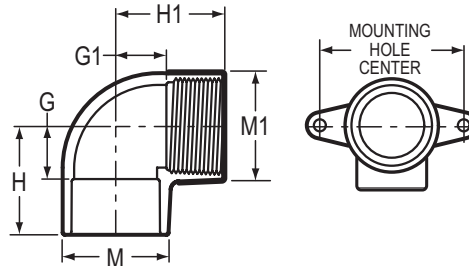

P	N	S	G	G	H	H	M	M	M _C	H	A	W . L .
DE4107-005SR		1/2	1/4	3/8	25/32	1-5/32	27/32	1-7/32		2-1/16		.07

0 STREET ELL

Spigot x Socket

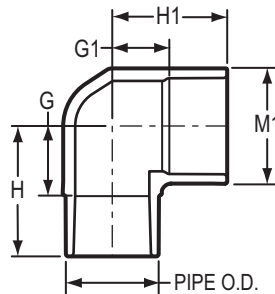

P	N	S	G	G	H	H	M	P O.D.	A	. W . L .
4109-005		1/2	1/2	13/32	1	15/16	27/32	5/8		.03
4109-007		3/4	11/16	9/16	1-5/16	1-5/16	1-1/16	7/8		.05
4109-010		1	1-11/16	13/16	1-11/16	1-23/32	1-3/8	1-1/8		.09

4 ELL

Socket x Socket

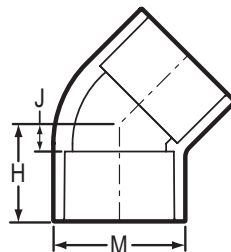

P	N	S	H	H	M	A	. W . L .
4117-005		1/2	3/4	3/16	13/16		.02
4117-007		3/4	1	5/16	1-1/16		.04
4117-010		1	1-1/4	11/32	1-11/32		.06
4117-012		1-1/4	1-1/2	13/32	1-21/32		.11
4117-015		1-1/2	1-3/4	7/16	1-31/32		.18
4117-020		2	2-1/4	17/32	2-9/16		.38

CPVC CTS FITTINGS & VALVES

4 STREET ELL

Spigot x Socket

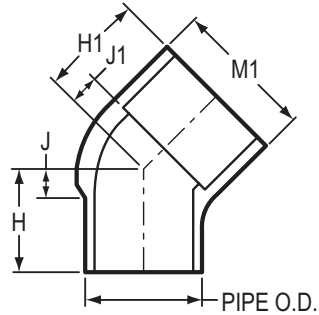

P	N	S	H	H			M	P	O.D.	A	.W . L .
4127-005		1/2	3/4	25/32	7/32	1/4	27/32		5/8		.02
4127-007		3/4	1-1/32	1-1/16	5/16	11/32	1-3/32		7/8		.04
4127-010		1	1-5/16	1-11/32	3/8	7/16	1-3/8		1-1/8		.06

COUPLING

Socket x Socket

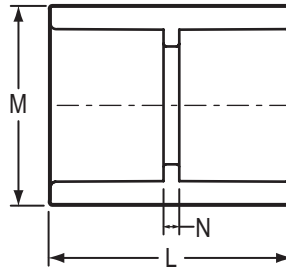

P	N	S	L	M	N	A	.W . L .
4129-005		1/2	1-5/32	27/32	3/32		.02
4129-007		3/4	1-9/16	1-1/16	1/8		.03
4129-010		1	1-15/16	1-3/8	1/8		.04
4129-012		1-1/4	2-3/8	1-21/32	3/16		.08
4129-015		1-1/2	2-3/4	1-31/32	1/8		.13
4129-020		2	3-9/16	2-9/16	1/8		.29

CPVC CTS FITTINGS & VALVES

REDUCER COUPLING

Socket x Socket

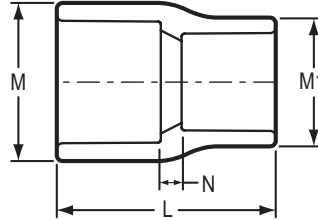

P	N	S	L	M	M	N	A	.W.	L
4129-101		3/4x1/2	1-3/8	1-3/32	27/32	1/8		.02	
4129-130*		1x1/2	2-7/32	1-11/32	1-11/32	25/32		.09	
4129-131		1x3/4	1-3/4	1-11/32	1-3/32	1/8		.04	
4129-166*		1-1/4x1/2	2-5/8	1-21/32	1-21/32	1		.14	
4129-167*		1-1/4x3/4	2-5/8	1-21/32	1-21/32	13/16		.15	
4129-168*		1-1/4x1	2-5/8	1-21/32	1-21/32	5/8		.13	
4129-209*		1-1/2x1/2	3-1/16	1-31/32	1-31/32	1-7/32		.24	
4129-210*		1-1/2x3/4	3-1/16	1-31/32	1-31/32	1-1/32		.23	
4129-211*		1-1/2x1	3-1/16	1-31/32	1-31/32	27/32		.23	
4129-212*		1-1/2x1-1/4	3-1/16	1-31/32	1-31/32	21/32		.19	
4129-247*		2x1/2	3-27/32	2-9/16	2-9/16	1-19/32		.49	
4129-248*		2x3/4	3-27/32	2-9/16	2-9/16	1-13/32		.50	
4129-249*		2x1	3-27/32	2-9/16	2-9/16	1-7/32		.50	
4129-250*		2x1-1/4	3-27/32	2-9/16	2-9/16	1-1/32		.49	
4129-251*		2x1-1/2	3-27/32	2-9/16	2-9/16	13/16		.47	

0

FEMALE ADAPTER

GASKET

Socket x NPSC

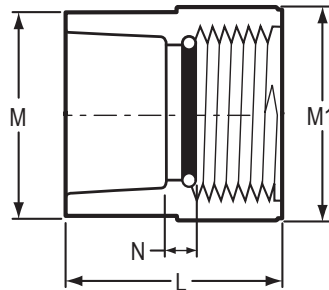

P	N	S	L	M	M	N	A	.W.	L
4135-005OR		1/2	1-11/32	27/32	1-3/16	7/32		.04	
4135-007OR		3/4	1-9/16	1-3/32	1-3/8	7/32		.05	
4135-010OR		1	1-15/16	1-3/8	1-11/16	1/16		.09	

CPVC CTS FITTINGS & VALVES

TRANSITION FEMALE ADAPTER

Socket x Metal Fipt

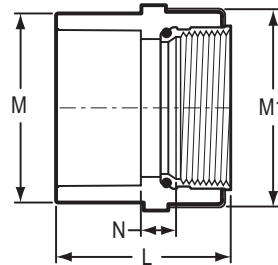

P	N	S	L	M	M	N	A	.W.	L
4135-005BR		1/2	1-13/32	29/32	1-7/32	1/4		.10	
4135-007BR		3/4	1-23/32	1-5/32	1-3/8	5/16		.13	

TRANSITION REDUCING FEMALE ADAPTER

Socket x Metal Fipt

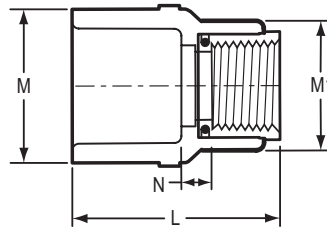

P	N	S	L	M	M	N	A	.W.	L
4135-101BR		3/4x1/2	1-5/8	1-5/32	1-3/16	1/4		.10	
4135-130BR		1x1/2	1-13/16	1-7/16	1-3/16	1/4		.07	

SPECIAL REINFORCED FEMALE ADAPTER

Socket x SR Fipt

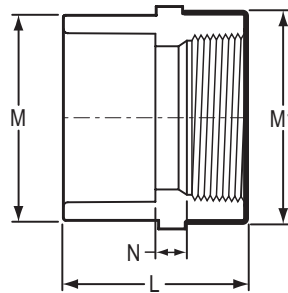

P	N	S	L	M	M	N	A	.W.	L
4135-005SR		1/2	1-3/8	27/32	1-7/32	3/32		.05	
4135-007SR		3/4	1-19/32	1-3/32	1-3/8	1/8		.06	
4135-010SR		1	1-15/16	1-3/8	1-23/32	1/8		.10	

CPVC CTS FITTINGS & VALVES

MALE ADAPTER

Mipt x Socket

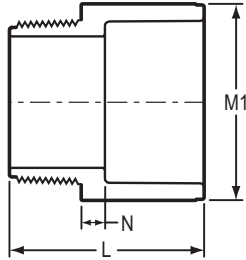

P	N	S	L	M	N	A	.W . L .
4136-005		1/2	1-1/4	7/8	3/16		.02
4136-007		3/4	1-19/32	1-3/32	7/32		.04
4136-010		1	1-7/8	1-11/32	7/32		.06
4136-012		1-1/4	2-9/32	1-21/32	5/16		.09
4136-015		1-1/2	2-15/32	1-31/32	5/16		.13
4136-020		2	2-29/32	2-9/16	5/16		.24

REINFORCED MALE ADAPTER

(Internal Stainless Steel Reinforced)

R Mipt x Socket

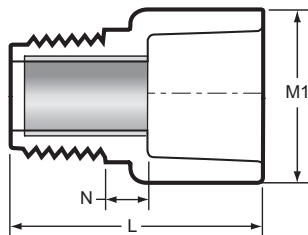

P	N	S	L	M	N	A	.W . L .
4136-005R		1/2	1-23/32	27/32	17/32		.04
4136-007R		3/4	1-15/16	1-3/32	9/16		.06
4136-010R		1	2-3/8	1-11/32	11/16		.11

MALE ADAPTER

Mipt x Socket

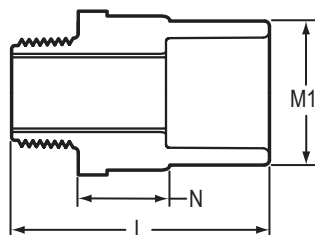

P	N	S	L	M	N	A	.W . L .
4136-007BR		3/4	2-1/4	1-3/16	13/16		.21

CPVC CTS FITTINGS & VALVES

MALE ADAPTER

Mipt x Spigot

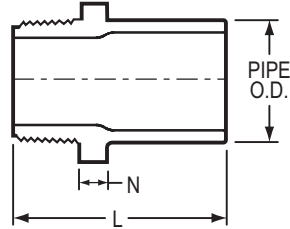

P	N	S	L	N	P	O.D.	A	.W.	L
4161-005		1/2	1-5/16	3/16		5/8			.02

REDUCER BUSHING

Spigot x Socket

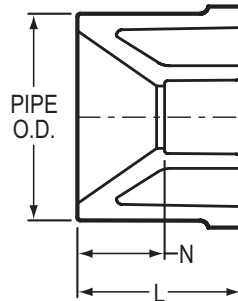

P	N	S	L	N	P	O.D.	A	.W.	L
4137-101		3/4x1/2	7/8	1/4		7/8			.01
4137-130		1x1/2	1-5/32	5/8		1-1/8			.05
4137-131		1x3/4	1-5/32	7/16		1-1/8			.03
4137-166		1-1/4x1/2	1-13/32	7/8		1-3/8			.06
4137-167		1-1/4x3/4	1-13/32	11/16		1-3/8			.06
4137-168		1-1/4x1	1-13/32	1/2		1-3/8			.04
4137-209		1-1/2x1/2	1-21/32	1-1/8		1-5/8			.10
4137-210		1-1/2x3/4	1-21/32	15/16		1-5/8			.10
4137-211		1-1/2x1	1-21/32	3/4		1-5/8			.09
4137-212		1-1/2x1-1/4	1-21/32	9/16		1-5/8			.06
4137-247		2x1/2	2	1-15/32		2-1/8			.20
4137-248		2x3/4	2	1-9/32		2-1/8			.21
4137-249		2x1	2	1-3/32		2-1/8			.21
4137-250		2x1-1/4	2	29/32		2-1/8			.20
4137-251		2x1-1/2	2	11/16		2-1/8			.18

CPVC CTS FITTINGS & VALVES

TRANSITION BUSHING

IPS Spigot x CTS Socket

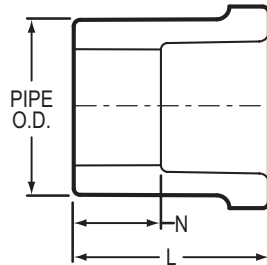

P	N	S	L	N	P O.D.	A	. W . L .
4140-005		1/2	31/32	7/16	27/32		.02
4140-007		3/4	1-7/32	1/2	1-1/16		.02
4140-010		1	1-3/8	15/32	1-5/16		.04
4140-012		1-1/4	1-17/32	3/8	1-21/32		.07
4140-015		1-1/2	1-21/32	5/16	1-29/32		.08
4140-020		2	1-15/16	3/16	2-3/8		.11

TRANSITION COUPLING

IPS Socket x CTS Socket

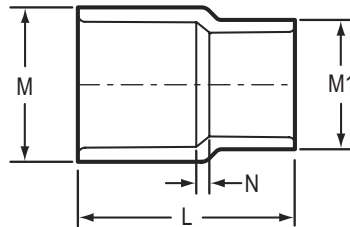

P	N	S	L	M	M	N	A	. W . L .
4141-007		3/4	1-27/32	1-5/16	1-3/32	1/8		.04
4141-010		1	2-5/32	1-19/32	1-3/8	1/8		.07

CPVC CTS FITTINGS & VALVES

CAP
Socket

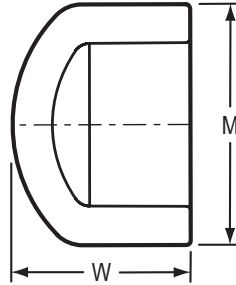

P N	S	M	W	A . W . L .
4147-005	1/2	27/32	13/16	.01
4147-007	3/4	1-1/16	1-1/16	.02
4147-010	1	1-3/8	1-5/16	.04
4147-012	1-1/4	1-21/32	1-19/32	.06
4147-015	1-1/2	1-31/32	1-29/32	.10
4147-020	2	2-9/16	2-7/16	.22

CTS BALL VALVES
w/EPDM O-ring Seals
Socket x Socket

100 psi Maximum
Internal Pressure @ 180°F

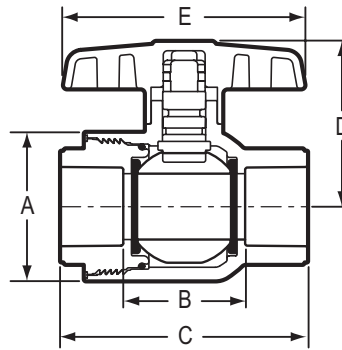

P N	S	A	B	C	D	E	A . W . L .	C
1922-005	1/2	1-11/32	1-1/16	2-1/4	1-5/16	2	.24	37
1922-007	3/4	1-3/4	1-1/2	2-31/32	1-23/32	2-23/32	.26	84
1922-010	1	2-1/32	1-5/8	3-3/8	2-7/16	3-1/2	.46	151
1922-012	1-1/4	2-9/16	1-31/32	3-7/8	2-13/16	3-3/4	.71	229
1922-015	1-1/2	2-15/16	2-1/2	4-11/16	2-15/16	4-1/4	1.05	330
1922-020	2	3-9/16	2-27/32	5-5/32	3-13/16	4-31/32	2.02	598

CPVC CTS FITTINGS & VALVES

CTS UNION

w/EPDM O-ring Seals
Socket x Socket

Pressure Rating
100 psi @ 180°F

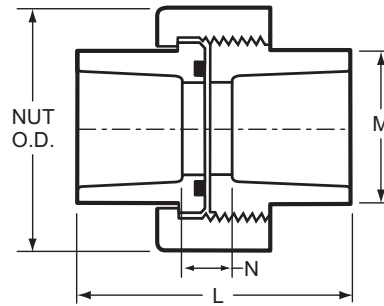

P	N	S	L	M	N	NUT O.D.	A	. W . L .
4197-005		1/2	2-7/32	1-1/32	1-5/32	1-25/32		.13
4197-007		3/4	2-3/32	1-9/32	5/8	1-15/16		.16
4197-010		1	1-17/32	1-1/2	9/16	2-1/2		.26