

Compression and Insert Tube Fittings



P
LASCO

**Welding &
Fabrication Inc.**

4268 Dundas St.
Thorndale, On N0M 2P0
Ph: 1.888.475.2726
www.plascowelding.com

Fast & Tite Thermoplastic Fittings

Fast & Tite fittings are the most complete line of plastic fittings for thermoplastic tubing in the industry.

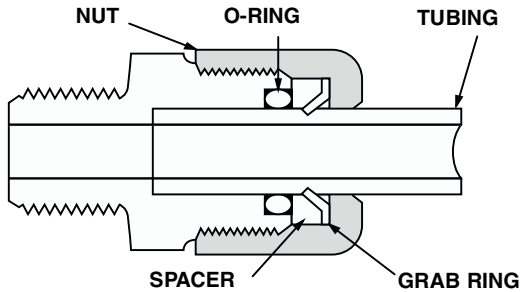

Fast & Tite thermoplastic tube fittings from Parker will prove to be the answer to your tubing connector needs. Patented Fast & Tite fittings install in seconds without tools and provide a tight, sure, leak proof seal without clamps or adjustments. A unique 302 stainless steel grab ring, for tube retention, coupled with a Nitrile O-Ring for positive seal, assures good tube connection with only hand tight assembly. A plastic grab ring is also available upon special request. Vibration or tube movement will not break the seal and cause leakage. Preassembled in either highly inert polypropylene, or strong, durable nylon, Fast & Tite fittings are the answer to full flow thermoplastic tubing system requirements.

When necessary, Fast & Tite fittings can be disassembled by hand for fast system drainage. Fittings are completely reusable. Parts are

easily replaced. O-Rings are standard size and universally available. (For applications requiring other than Nitrile O-Rings, consult your Fast & Tite distributor.)

Use Fast & Tite fittings with Parker Parflex tubing or other plastic, glass or metal tubing for low pressure or vacuum lines up to the pressure limits shown below.

All ingredients in Fast & Tite fittings meet FDA and NSF requirements for food contact and potable water.

Working Pressures for Fast & Tite Fittings

Tube O. D., in.	Air-Oil-Water Pressure in PSI		
	Up to 75°F	76° to 125°F	126° to 175°F
1/4	300	300	300
5/16	300	300	300
3/8	250	250	150
1/2	200	200	150
5/8	150	100	50

Ratings are based on use with copper tubing, and in all cases represent the maximum recommended working pressure of the fitting only. Working pressures (vs. temperatures) of other types of tubing may limit the tube and fitting assembly to pressures lower than shown above. [Consult factory for recommendations on applications other than shown above.](#)

Temperature Range:

Black/White Polypropylene: 0°F (-18°C) to +212°F (+100°C).
White Nylon: -40°F (-40°C) to +200°F (+93°C)

Fast Assembly

Step 1.

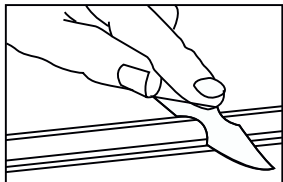

Cut the tube squarely and remove any burrs.

Step 2.

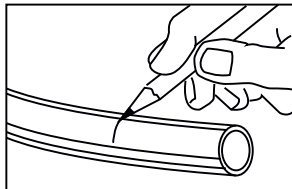

Mark from end of tube the length of insertion. (See Table)

Tube Size	Insertion Length with Tube Support in.	Insertion Length without Tube Support in.
1/4 O. D.	5/8	9/16
5/16 O. D.	5/8	9/16
3/8 O. D.	13/16	3/4
1/2 O. D.	7/8	13/16
5/8 O. D.	1	15/16

Step 3.

Loosen nut on fitting until three threads are visible. Fittings for glass tubes must be disassembled and the grab ring removed.

Step 4.

Moisten end of the tube with water. Push the tube **Straight** into fitting until it bottoms on the fitting's shoulder. Tighten nut by hand. Additional tightening should not be necessary, but 1/4 additional turn may be added if desired. **Do not overtighten** nut as the threads will strip and the fitting will not function properly. A proper assembly will not show the insertion mark extending beyond the nut. If the insertion mark is visible, then steps 1 thru 4 must be repeated.

Step 5.

When using clear vinyl tubing or urethane tubing, it is necessary to use a **TS** tube support. Disassemble the fitting and place the nut, grab ring, spacer and tube support, in that order on the tube. Locate the grab ring at the insertion mark as shown. Seat the O-ring in the body, then proceed with Step 4.

Note: Provide adequate fail-safe mechanisms such as leakage detection sensors, automatic shut-off controls or other industry and code appropriate fail-safe devices in the design of your water-handling appliance to protect against personal injury and property damage. Plastic fittings containing an o-ring that are used in water applications should be replaced at least every five years or more frequently depending on the environment and severity of the application.



MC - Male Connector

Tube to male pipe

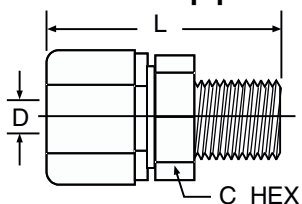

Black Polypropylene Part Number	Price	Nom. Tube O. D.	NPTF Thread Size	C Hex	L Overall Length	D Thru-Hole Min.
#	\$					
P4MC2	6.05	1/4	1/8	11/16	1.38	.170
P4MC4	6.28	1/4	1/4	11/16	1.51	.170
P4MC6	12.67	1/4	3/8	11/16	1.48	.170
P5MC2	7.70	5/16	1/8	11/16	1.38	.170
P5MC4	7.73	5/16	1/4	11/16	1.50	.250
P6MC2	7.82	3/8	1/8	13/16	1.50	.170
P6MC4	7.65	3/8	1/4	13/16	1.67	.250
P6MC6	8.45	3/8	3/8	13/16	1.67	.250
P6MC8	8.66	3/8	1/2	1	1.78	.250
P6MC12	9.14	3/8	3/4	1	1.84	.250
P8MC2	9.00	1/2	1/8	1	1.61	.170
P8MC4	9.40	1/2	1/4	1	1.74	.250
P8MC6	11.50	1/2	3/8	1	1.74	.375
P8MC8	12.01	1/2	1/2	1	1.87	.375
P8MC12	12.82	1/2	3/4	1	1.89	.375
P10MC2	13.29	5/8	1/8	1-1/8	1.75	.170
P10MC4	13.63	5/8	1/4	1-1/8	1.90	.250
P10MC6	13.63	5/8	3/8	1-1/8	1.90	.375
P10MC8	14.49	5/8	1/2	1-1/8	2.01	.500
P10MC12	15.10	5/8	3/4	1-1/8	2.04	.500

UC - Union Connector

Tube to tube

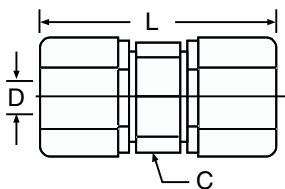

Black Polypropylene Part Number	Price	Nom. Tube O. D.	C Hex	L Overall Length	D Thru-Hole Min.
#	\$				
P4UC4	9.17	1/4	11/16	1.62	.170
P5UC4	11.39	5/16-1/4	11/16	1.62	.170
P5UC5	11.52	5/16	11/16	1.62	.190
P6UC4	12.00	3/8-1/4	13/16	1.80	.170
P6UC5	12.64	3/8-5/16	13/16	1.80	.190
P6UC6	13.28	3/8	13/16	1.92	.250
P8UC6	14.77	1/2-3/8	1	1.95	.250
P8UC8	14.85	1/2	1	2.03	.375
P10UC6	15.38	5/8-3/8	1-1/8	2.19	.250
P10UC8	16.25	5/8-1/2	1-1/8	2.24	.375
P10UC10	18.09	5/8	1-1/8	2.40	.500

ME - Male Elbow

Tube to male pipe

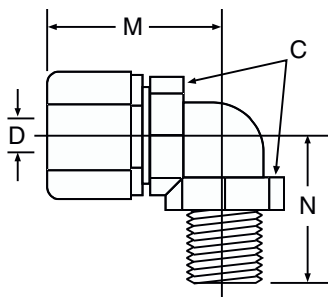

Black Polypropylene Part Number	Price	Nom. Tube O. D.	NPTF Thread Size	C Hex	M	N	D Thru-Hole Min.
#	\$						
P4ME2	8.09	1/4	1/8	3/4	1.06	0.81	.170
P4ME4	8.23	1/4	1/4	3/4	1.06	1.02	.170
P4ME6	8.15	1/4	3/8	3/4	1.06	1.02	.170
P5ME2	9.40	5/16	1/8	3/4	1.06	0.81	.193
P5ME4	9.52	5/16	1/4	3/4	1.06	1.02	.193
P5ME6	12.84	5/16	3/8	3/4	1.06	1.02	.193
P6ME4	11.15	3/8	1/4	7/8	1.28	1.12	.250
P6ME6	11.76	3/8	3/8	7/8	1.28	1.12	.250
P6ME8	13.15	3/8	1/2	1-1/8	1.28	1.34	.250
P6ME12	13.29	3/8	3/4	1-3/16	1.59	1.40	.250
P8ME4	13.65	1/2	1/4	1-1/16	1.48	1.22	.250
P8ME6	13.88	1/2	3/8	1-1/16	1.56	1.21	.375
P8ME8	14.02	1/2	1/2	1-1/16	1.56	1.34	.375
P8ME12	22.91	1/2	3/4	1-1/8	1.50	1.40	.375
P10ME8	15.26	5/8	1/2	1-3/16	1.72	1.40	.500

E

EU - Elbow Union

Tube to tube

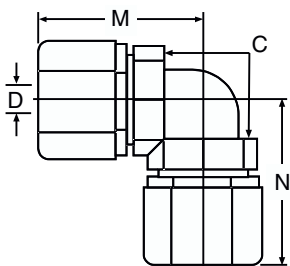

Black Polypropylene Part Number	Price	Nom. Tube O. D.	C Hex	M	N	D Thru-Hole Min.
#	\$					
P4EU4	12.34	1/4	3/4	1.06	1.06	.170
P5EU4	14.00	5/16-1/4	3/4	1.06	1.06	.170
P5EU5	14.52	5/16	3/4	1.06	1.06	.193
P6EU4	15.62	3/8-1/4	7/8	1.06	1.28	.170
P6EU5	16.48	3/8-5/16	7/8	1.06	1.28	.170
P6EU6	17.05	3/8	7/8	1.28	1.28	.250
P8EU6	18.98	1/2-3/8	1-1/16	1.37	1.56	.250
P8EU8	18.93	1/2	1-1/16	1.56	1.56	.375
P10EU10	21.11	5/8	1-3/16	1.72	1.72	.500

BU - Bulkhead Union

Tube to tube

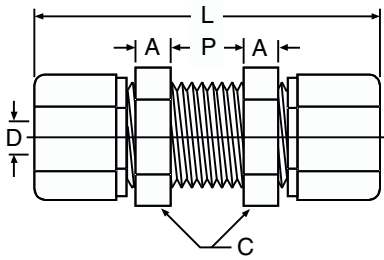

Black Polypropylene Part Number	Price	Nom. Tube O. D.	A Ref.	C Hex	L Overall Length	P Max.	D Thru-Hole Min.	Bulkhead Hole Drill Size
#	\$							
P4BU4	22.37	1/4	1/4	13/16	2-11/64	3/8	.170	21/32
P5BU5	22.59	5/16	1/4	13/16	2-11/64	3/8	.187	21/32
P6BU6	23.30	3/8	9/32	15/16	2-39/64	1/2	.250	25/32
P8BU8	25.23	1/2	5/16	1-5/32	2-3/4	1/2	.375	31/32

FE - Female Elbow

Tube to female pipe

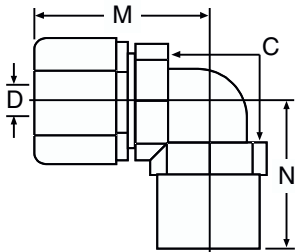

Black Polypropylene Part Number	Price	Nom. Tube O. D.	NPTF Thread Size	C Hex	M	N	D Thru-Hole Min.
#	\$						
P4FE2	9.28	1/4	1/8	11/16	1.10	0.84	.170
P4FE4	10.59	1/4	1/4	11/16	1.10	0.97	.170
P5FE2	11.89	5/16	1/8	11/16	1.10	0.84	.193
P6FE4	12.11	3/8	1/4	13/16	1.30	1.06	.250
P6FE6	12.11	3/8	3/8	13/16	1.30	1.03	.250
P8FE6	12.58	1/2	3/8	1	1.50	1.16	.375
P8FE8	12.92	1/2	1/2	1	1.50	1.27	.375
P10FE8	14.94	5/8	1/2	1-1/8	1.70	1.34	.500

FC - Female Connector

Tube to female pipe

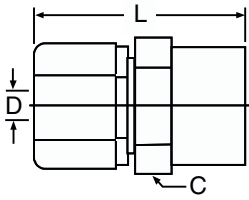

Black Polypropylene Part Number	Price	Nom. Tube O. D.	NPTF Thread Size	C Hex	L Overall Length	D Thru-Hole Min.
#	\$					
P4FC2	10.85	1/4	1/8	11/16	1.30	.170
P4FC4	10.94	1/4	1/4	11/16	1.40	.170
P6FC4	11.56	3/8	1/4	1	1.57	.250
P6FC6	11.51	3/8	3/8	1-1/8	1.57	.250
P6FC8	11.89	3/8	1/2	1-1/8	1.67	.250
P8FC6	12.77	1/2	3/8	1	1.66	.375
P8FC8	14.48	1/2	1/2	1-1/8	1.78	.375
P10FC8	14.35	5/8	1/2	1-1/8	1.95	.500

MR - Male Run Tee

Tube to male pipe

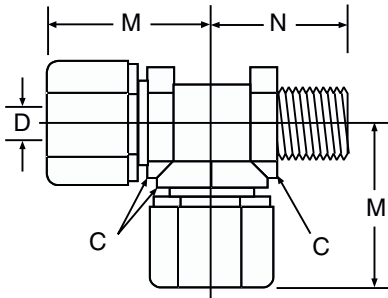

Black Polypropylene Part Number	Price	Nom. Tube O. D.	NPTF Thread Size	C Hex	M	N	D Thru-Hole Min.
#	\$						
P4MR2	11.30	1/4	1/8	11/16	1.09	0.89	.170
P6MR4	15.76	3/8	1/4	13/16	1.30	1.17	.250
P8MR6	20.28	1/2	3/8	1	1.46	1.28	.375
P10MR8	25.42	5/8	1/2	1-1/8	1.68	1.50	.500

TU - Tee Union

Tube to tube

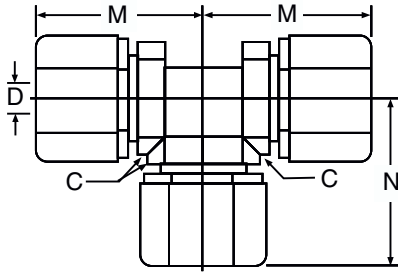

Black Polypropylene Part Number	Price	Nom. Tube O. D.	C Hex	M	N	D Thru-Hole Min.
#	\$					
P4TU4	15.70	1/4	11/16	1.09	1.09	.170
P5TU5	20.37	5/16	11/16	1.09	1.09	.187
P6TU6	21.11	3/8	13/16	1.30	1.30	.250
P8TU6	23.96	1/2-3/8	1	1.46	1.39	.250
P8TU8	24.84	1/2	1	1.46	1.46	.375
P10TU6	26.18	5/8-3/8	1-1/8	1.68	1.46	.250
P10TU10	28.56	5/8	1-3/16	1.68	1.68	.500

MT - Male Branch Tee

Tube to male pipe

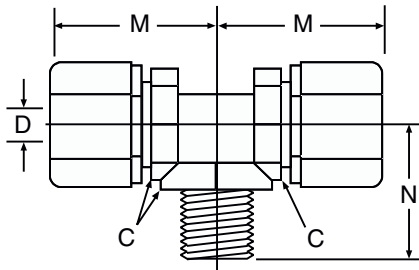

Black Polypropylene Part Number	Price	Nom. Tube O. D.	NPTF Thread Size	C Hex	M	N	D Thru-Hole Min.
#	\$						
P4MT2	11.27	1/4	1/8	11/16	1.09	0.89	.170
P4MT4	11.72	1/4	1/4	11/16	1.09	1.06	.170
P5MT4	18.43	5/16	1/4	11/16	1.09	1.06	.187
P6MT4	15.76	3/8	1/4	13/16	1.30	1.12	.250
P6MT6	15.76	3/8	3/8	13/16	1.30	1.10	.250
P8MT6	18.83	1/2	3/8	1	1.46	1.22	.375
P8MT8	19.38	1/2	1/2	1	1.46	1.43	.375
P10MT8	21.21	5/8	1/2	1-1/8	1.68	1.41	.500

GR - Grab Ring (Stainless or Plastic)



Plastic Grab Ring Part Number	Price	For Nom. Tube O. D.
#	\$	
4GRP	1.66	1/4
5GRP	1.80	5/16
6GRP	2.21	3/8
8GRP	2.17	1/2
10GRP	2.13	5/8

OR - O-Ring

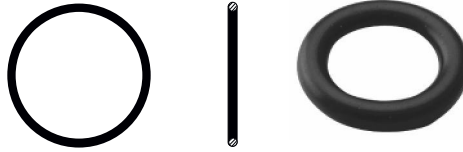

NS - Nut and Spacer Sets

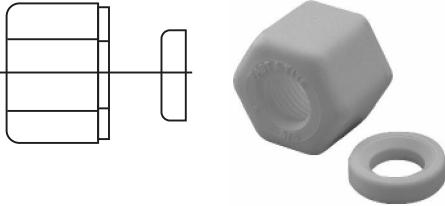

Black Polypropylene Part Number	Price	For Nom. Tube O. D.
#	\$	
P4NS	2.40	1/4
P5NS	2.73	5/16
P6NS	2.73	3/8
P8NS	3.05	1/2
P10NS	4.07	5/8

TS - Tube Support

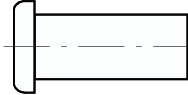

Polypropylene Part Number	Price
#	\$
P4TS3	2.28
P6TS4	2.98
P8TS6	3.31
P10TS8	3.41

E

Thermoplastic Fittings

Par-Barb Fittings

Par-Barb Thermoplastic Fittings

Par-Barb fittings are precision injection molded from high-strength, chemically inert, thermoplastic materials.

The specially engineered four-barb design generates the maximum gripping and sealing power when combined with a hose clamp. The unique barb design requires the tube or hose to expand slightly to accept the fitting, providing a positive seal on the barbs.

Par-Barb fittings are widely used with Parflex clear vinyl tubing, urethane tubing and a variety of rubber tubing and hose. Par-Barb fittings meet FDA and NSF specifications for food contact and potable water.*

Par-Barb is recommended in medical, pollution control, food and beverage applications. Other uses include irrigation, instrumentation, reverse osmosis and deionized water systems.

Temperature range:

Black Polyethylene: -65°F (-54°C) to +190°F (+88°C.)

White Nylon: -40°F (-40°C) to +200°F (+93°C.)

Working Pressures:

Par-Barb fittings are generally used in systems where pressures do not exceed 125 psi. When used in excess of 125 psi, Par-Barb fittings, in all sizes, should be tested by the customer in his particular application. Operating pressures of Par-Barb fittings are governed by ambient and fluid temperatures, type of fluid conveyed, hose or tubing used, clamping mechanism employed and conditions of mechanical abuse.

How to order Par-barb fittings:

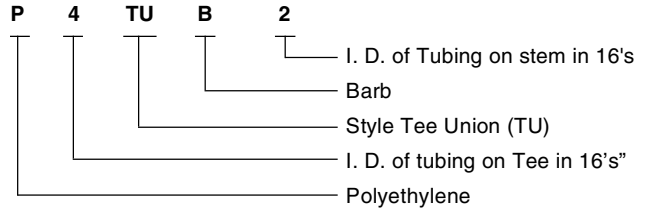

TUB - Tee Union

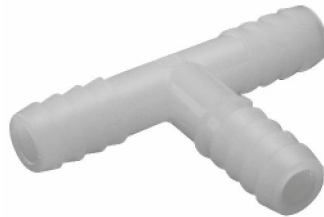
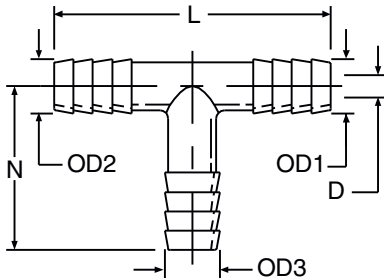

Black High Density Linear Polyethylene Part Number	Price	Tube or Hose I.D. 1 & 2	Tube or Hose I.D. 3	O.D. 1 & 2	O.D. 3	L	N	D Flow Diameter
#	\$	⊙	⊙	⊙	⊙			⊘
P2TUB2	3.96	1/8	1/8	.141	.141	1.203	0.594	.078
P3TUB3	3.96	3/16	3/16	.245	.245	1.941	1.256	.106
P4TUB3	4.35	1/4	3/16	.308	.245	2.004	1.256	.106
P4TUB4	4.04	1/4	1/4	.308	.308	2.004	1.256	.153
P5TUB5	4.13	5/16	5/16	.361	.361	2.058	1.256	.215
P6TUB4	4.13	3/8	1/4	.425	.308	2.121	1.256	.153
P6TUB6	4.21	3/8	3/8	.425	.425	2.134	1.256	.247
P6TUB8	4.28	3/8	1/2	.425	.550	2.121	1.256	.247
P8TUB6	4.35	1/2	3/8	.550	.425	2.248	1.256	.247
P8TUB8	4.88	1/2	1/2	.550	.550	2.248	1.256	.372
P10TUB8	7.34	5/8	1/2	.644	.550	2.340	1.256	.372
P10TUB10	4.92	5/8	5/8	.644	.644	2.340	1.256	.465

*P2UCB2, P2TUB2, P12HPN6 are not FDA compliant.

Thermoplastic Fittings
Par-Barb Fittings

EUB - Elbow Union

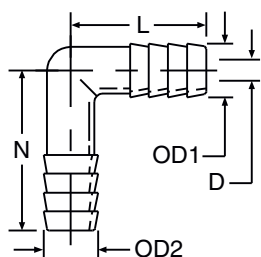

Black High Density Linear Polyethylene Part Number	Price	Tube or Hose I. D.		O. D. 1	O. D. 2	L	N	D Flow Diameter
		1	2					
#	\$							
P4EUB4	3.96	1/4	1/4	.308	.308	1.002	1.256	.153
P6EUB6	4.11	3/8	3/8	.425	.425	1.060	1.256	.247
P8EUB4	4.13	1/2	1/4	.550	.308	1.002	1.256	.153
P8EUB6	4.53	1/2	3/8	.550	.425	1.060	1.256	.247
P8EUB8	4.28	1/2	1/2	.550	.550	1.123	1.256	.372
P10EUB10	4.43	5/8	5/8	.644	.644	1.170	1.256	.465
P12EUB12	8.09	3/4	3/4	.788	.788	1.242	1.256	.606



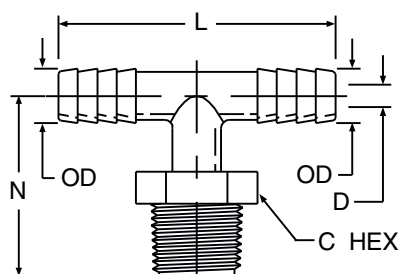

MTB - Tee Male Branch



Black High Density Linear Polyethylene Part Number	Price	Tube or Hose I.D.	NPTF Pipe Thread Size	O.D.	C Hex	L	N	D Flow Diameter
P3MTB2	4.17	3/16	1/8	.245	7/16	1.941	1.187	.106
P3MTB4	4.60	3/16	1/4	.245	9/16	1.941	1.406	.106
P4MTB2	4.28	1/4	1/8	.308	7/16	2.004	1.187	.153
P4MTB4	4.22	1/4	1/4	.308	9/16	2.004	1.406	.153
P4MTB6	5.04	1/4	3/8	.308	11/16	2.004	1.436	.153
P6MTB4	4.50	3/8	1/4	.425	9/16	2.121	1.406	.247
P6MTB6	5.99	3/8	3/8	.425	11/16	2.121	1.436	.247
P6MTB8	5.10	3/8	1/2	.425	7/8	2.121	1.626	.247
P8MTB4	4.50	1/2	1/4	.550	9/16	2.246	1.406	.281
P8MTB6	4.92	1/2	3/8	.550	11/16	2.246	1.436	.372
P8MTB8	5.28	1/2	1/2	.550	7/8	2.246	1.626	.372

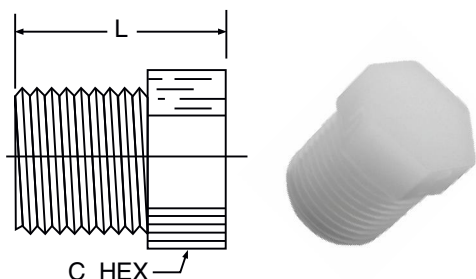



HPL - Hex Head Pipe Plug

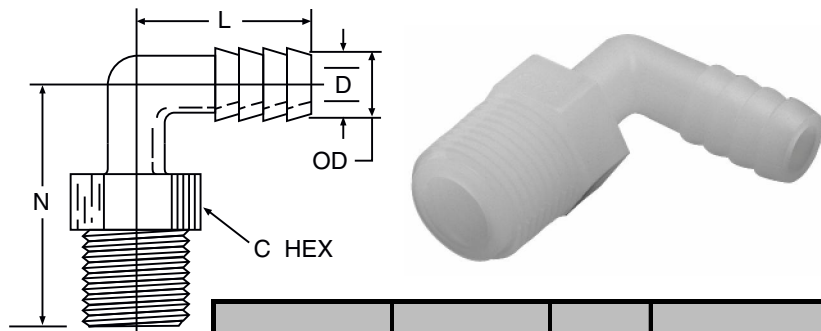

Black High Density Linear Polyethylene Part Number	Price	NPTF Pipe Thread	C Hex	L Overall Length
#	\$			
P2HPL	1.30	1/8	7/16	0.660
P4HPL	1.30	1/4	9/16	0.880
P6HPL	1.64	3/8	11/16	0.905
P8HPL	2.19	1/2	7/8	1.092
P12HPL	3.66	3/4	1-1/8	1.115

MEB - Male Elbow Connector

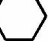

Black High Density Linear Polyethylene Part Number	Price	Tube or Hose I. D.	NPTF Pipe Thread	C Hex	O. D.	L	N	D Flow Diameter
#	\$							
P3MEB2	4.04	3/16	1/8	7/16	.245	0.971	1.186	.106
P3MEB4	4.28	3/16	1/4	9/16	.245	0.971	1.406	.106
P4MEB2	4.11	1/4	1/8	7/16	.308	1.002	1.186	.153
P4MEB4	4.24	1/4	1/4	9/16	.308	1.002	1.406	.153
P4MEB6	5.05	1/4	3/8	11/16	.308	1.002	1.436	.153
P4MEB8	5.10	1/4	1/2	7/8	.308	1.002	1.626	.153
P4MEB12	5.28	1/4	3/4	1-1/8	.308	1.002	1.636	.153
P6MEB2	4.04	3/8	1/8	7/16	.425	1.060	1.186	.247
P6MEB4	4.03	3/8	1/4	9/16	.425	1.060	1.406	.247
P6MEB6	5.16	3/8	3/8	11/16	.425	1.060	1.436	.247
P6MEB8	5.39	3/8	1/2	7/8	.425	1.060	1.626	.247
P6MEB12	5.70	3/8	3/4	1-1/8	.425	1.060	1.636	.247
P8MEB4	4.29	1/2	1/4	9/16	.550	1.123	1.406	.372
P8MEB6	4.78	1/2	3/8	11/16	.550	1.123	1.436	.372
P8MEB8	5.28	1/2	1/2	7/8	.550	1.123	1.626	.372
P8MEB12	5.70	1/2	3/4	1-1/8	.550	1.123	1.636	.372
P10MEB6	5.21	5/8	3/8	11/16	.644	1.170	1.436	.465
P10MEB8	5.76	5/8	1/2	7/8	.644	1.170	1.626	.465
P10MEB12	6.24	5/8	3/4	1-1/8	.644	1.170	1.636	.465
P12MEB8	6.03	3/4	1/2	7/8	.788	1.242	1.626	.606

UCB - Union Connector

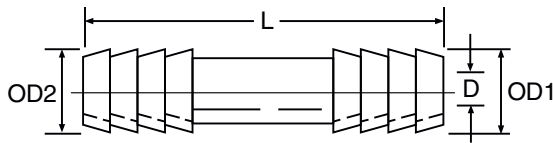

Black High Density Polyethylene Part Number	Price	1	2	O. D. 1	O. D. 2	L	D Flow Diameter
#	\$						
P2UCB2	3.11	1/8	1/8	.152	.152	.625	.050
P3UCB3	3.34	3/16	3/16	.245	.245	1.750	.106
P4UCB3	2.84	1/4	3/16	.308	.245	1.750	.106
P4UCB4	2.84	1/4	1/4	.308	.308	1.750	.153
P5UCB5	3.34	5/16	5/16	.361	.361	1.750	.215
P6UCB4	3.44	3/8	1/4	.425	.308	1.750	.153
P6UCB6	3.34	3/8	3/8	.425	.425	1.733	.247
P8UCB4	3.36	1/2	1/4	.550	.308	1.750	.153
P8UCB6	3.36	1/2	3/8	.550	.425	1.750	.247
P8UCB8	3.41	1/2	1/2	.550	.550	1.750	.372
P10UCB6	3.49	5/8	3/8	.644	.425	1.750	.247
P10UCB8	3.52	5/8	1/2	.644	.550	1.750	.372
P10UCB10	3.40	5/8	5/8	.644	.644	1.750	.465

HPN - Hex Pipe Nipple

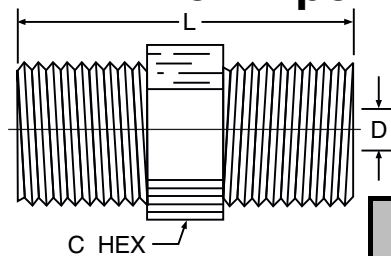

Black High Density Linear Polyethylene Part Number	Price	Side 1	Side 2	C Hex	L	D1 Diameter	D2 Diameter
#	\$						
P2HPN2	2.07	1/8	1/8	7/16	1.062	.187	.187
P4HPN2	2.15	1/4	1/8	9/16	1.281	.286	.187
P4HPN4	2.43	1/4	1/4	9/16	1.469	.285	.285
P6HPN2	3.34	3/8	1/8	11/16	1.332	.406	.187
P6HPN4	3.02	3/8	1/4	11/16	1.488	.406	.285
P6HPN6	3.53	3/8	3/8	11/16	1.500	.406	.406
P8HPN2	2.82	1/2	1/8	7/8	1.485	.618	.187
P8HPN4	2.91	1/2	1/4	7/8	1.687	.618	.285
P8HPN6	2.96	1/2	3/8	7/8	1.687	.618	.406
P8HPN8	3.32	1/2	1/2	7/8	1.875	.618	.618
P12HPN6	3.05	3/4	3/8	1-1/8	1.703	.750	.408
P12HPN8	4.60	3/4	1/2	1-1/8	1.891	.750	.618
P12HPN12	5.44	3/4	3/4	1-1/8	1.932	.750	.750

E

MCB - Male Connector Adapter

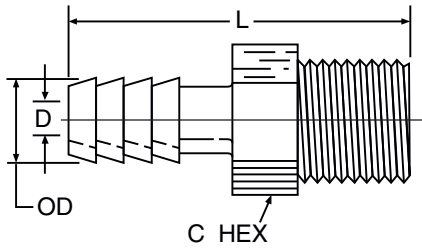

Black High Density Linear Polyethylene Part Number	Price	Tube or Hose I. D.	NPTF Pipe Thread	C Hex	O. D.	L	D Flow Diameter
#	\$						
P3MCB2	2.06	3/16	1/8	7/16	.245	1.530	.106
P3MCB4	2.15	3/16	1/4	9/16	.245	1.750	.106
P3MCB8	2.60	3/16	1/2	7/8	.245	1.970	.106
P4MCB2	1.87	1/4	1/8	7/16	.308	1.530	.153
P4MCB4	1.87	1/4	1/4	9/16	.308	1.750	.153
P4MCB6	2.15	1/4	3/8	11/16	.308	1.780	.153
P4MCB8	3.11	1/4	1/2	7/8	.308	1.970	.153
P4MCB12	5.10	1/4	3/4	1-1/8	.308	1.980	.153
P5MCB2	3.34	5/16	1/8	7/16	.361	1.530	.215
P5MCB4	2.21	5/16	1/4	9/16	.361	1.750	.215
P5MCB6	2.40	5/16	3/8	11/16	.361	1.780	.215
P6MCB2	3.38	3/8	1/8	7/16	.425	1.530	.247
P6MCB4	1.87	3/8	1/4	9/16	.425	1.750	.247
P6MCB6	2.15	3/8	3/8	11/16	.425	1.780	.247
P6MCB8	2.98	3/8	1/2	7/8	.425	1.970	.247
P6MCB12	3.75	3/8	3/4	1-1/8	.425	1.980	.247
P8MCB4	3.44	1/2	1/4	9/16	.550	1.750	.372
P8MCB6	2.60	1/2	3/8	11/16	.550	1.780	.372
P8MCB8	3.49	1/2	1/2	7/8	.550	1.970	.372
P8MCB12	4.03	1/2	3/4	1-1/8	.550	1.980	.372
P10MCB6	3.49	5/8	3/8	11/16	.644	1.780	.465
P10MCB8	3.49	5/8	1/2	7/8	.644	1.970	.465
P10MCB12	3.69	5/8	3/4	1-1/8	.644	1.980	.465
P12MCB8	3.49	3/4	1/2	7/8	.788	1.970	.606
P12MCB12	4.04	3/4	3/4	1-1/8	.788	1.980	.606